

## PP1142

PCI Express to USB 3.1 Type C Drive Bay Docking System  
(3.5 inch Front Panel Form Factor)

Product > USB 3.1 Products > PP1142



### First Impression

PP1142 is USB 3.1 Front Panel slides easily into any standard 3.5-inch drive bay, so in just three simple steps you'll enjoy the benefits of USB 3.1's 10Gbit/s transfer speeds:

### General Feature

- Bridge PCI Express to USB 3.1
- Upload firmware through BIOS or external SPI ROM
- External 20MHz differential crystal
- Overclock capability on PCI Express bus under asynchronous mode
- integrate Spread Spectrum controller for PCI Express and USB3.1 interface
- Integrate two regulators for normal core power supply and suspend core power supply
- Support driver on Windows 7, Windows 8, and Windows 8.1
- Support various Linux Kernels

## PCI Express Feature

- Support PCI Express Gen2x2 or Gen3x1
- Up to 10Gbps bandwidth performance with low latency
- Support PCI Express Link power management
- Compliant with PCI Express Base 3.0 Specification
- Compliant with PCI Express card Electromechanical 2.0 specification
- Compliant with PCI Express Mini Card Electromechanical 1.2 specification
- Compliant with Express Card Standard Revision 2.0
- Compliant with PCI Bus Power Management Interface Specification Revision 1.2
- Compliant with PCI Local Bus Specification Revision 3.0
- Support overclocking capability on PCI Express interface

## USB Feature

- Support two port of USB3.1
- Compliant with Universal Serial Bus 3.1 Specification Revision 1.0
- Compliant with Universal Serial Bus Specification Revision 2.0
- Compliant with eXtensible Host Controller Interface specification Revision 1.1
- Compliant with USB Attached SCSI Protocol Revision 1.0
- Support USB3.1 and USB2.0 Link Power Management
- Support Control, Bulk, Stream, Interrupt, Isochronous transfer type
- Support independent port power control
- Support over current detection
- Support Remote/Wakeup event
- Backward compatible with Legacy USB function and device
- Support the Debug port

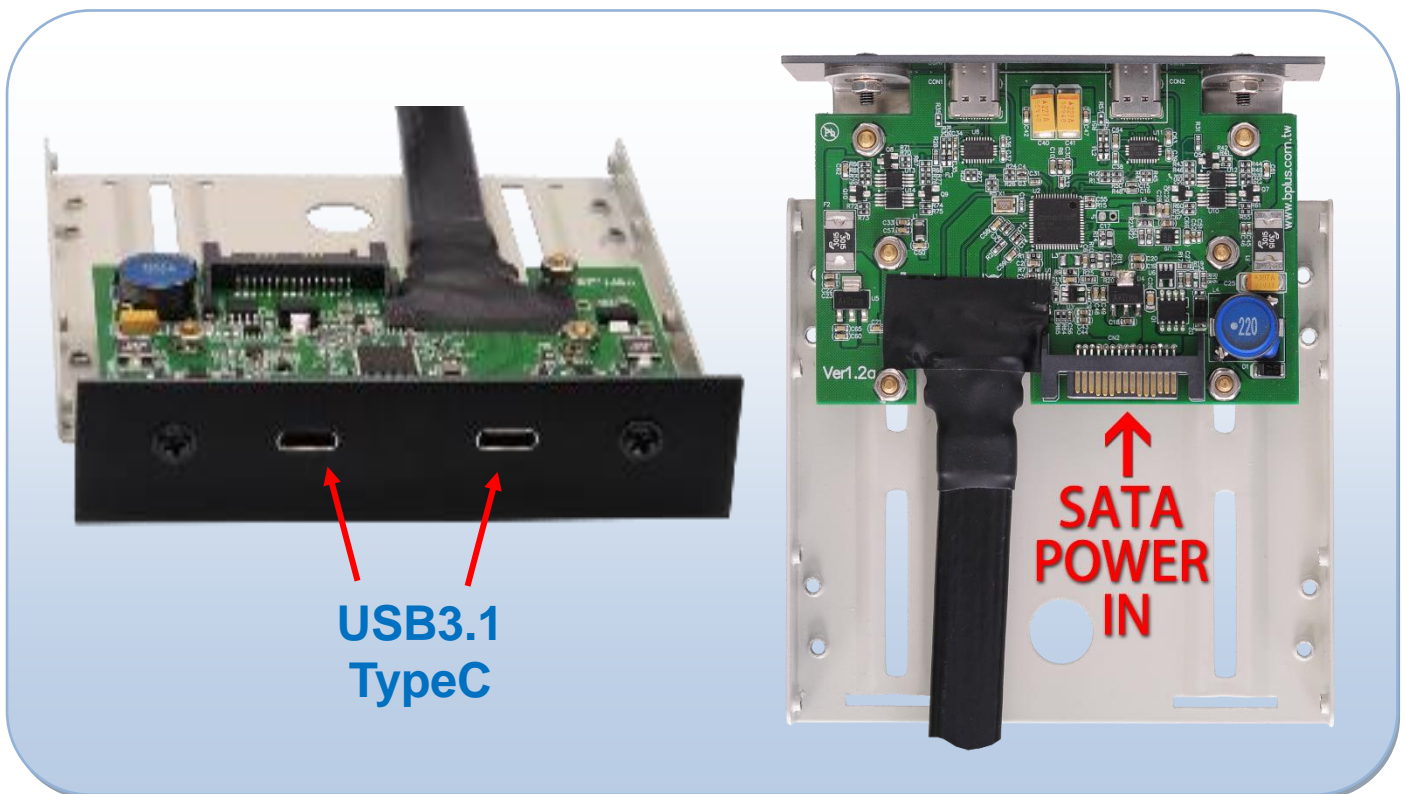

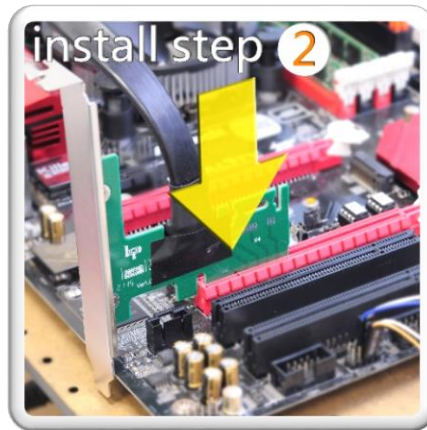

### PP1142 Package Contents

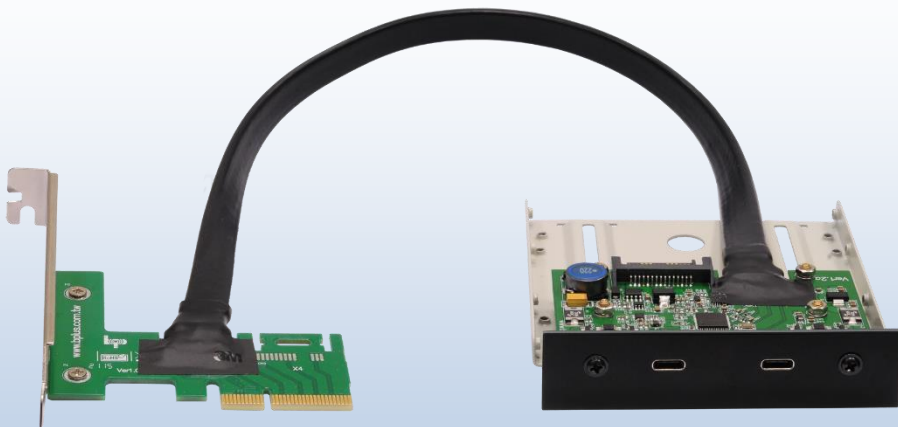

**PP1142**  
(PCI Express to USB 3.1 Type C Front Drive Bay Docking System) x1

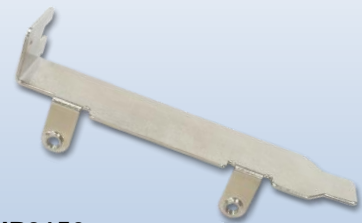

**JP0156**  
(Low profile PCI express bracket) x1