

# MR17 ( mSATA to Dual microSDXC UHS-I Adapter )

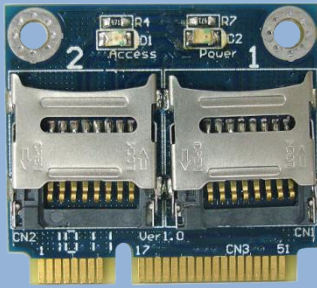

MR17 is mSATA to Dual microSDXC / UHS-I Card adapter for laptop PCs. Up to two microSD cards can easily be installed into mSATA slot of laptop PCs with MR17 for providing alternative system boot drive or additional built-in storage disk for vacant mSATA slot.

MR17 can support SDXC up to 2TB capacity and UHS-I 200MHz bus speed.

MR17 is the best solution for microSD Cards to adapt to mSATA.

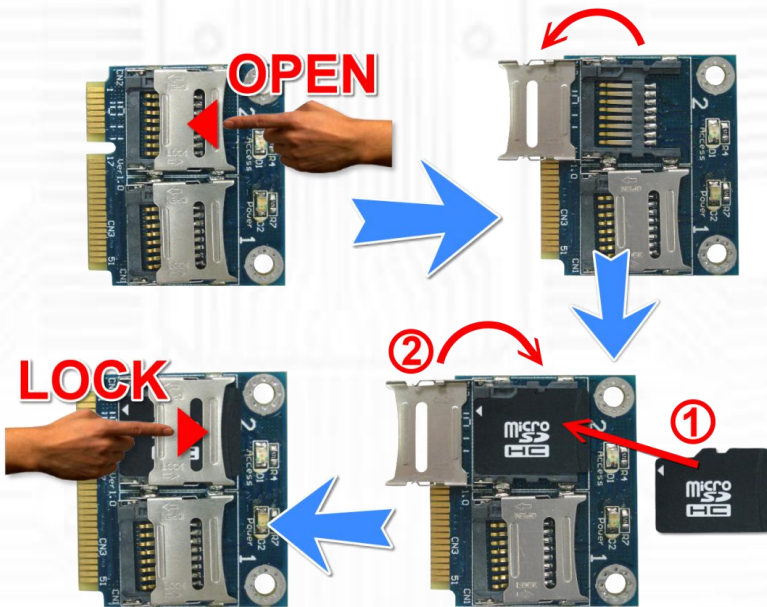

## Key Features

- Designed for use with laptop / netbook PCs.
- microSD card capacity: Up to 2TB, Support SDXC.
- Extreme high speed: Transfer files up to 100MB/sec. 200MHz(max)/4bit for SD UHS-I.
- Note: Actual throughput may vary based on the SD card speed and computer configuration.
- Compatible with Windows 7 / Vista / XP sp3 (Use Microsoft Inbox driver)

## Product Specification

- SD memory Card Specification Version 3.0 Compliant
  - Support microSDXC, SDHC, SDSC: Up to 2GB
  - Support UHS-I: SDR104, SDR50, SDR25, SDR12, HS, DS
  - Maximum SD bus clock is up to 200MHz-
- Compliant with Serial ATA Specification version 2.6.
  - Support 1.5Gbps (Gen 1)
  - Power management function (Partial/Slumber)
  - Smart SATA – SD conversion
  - Support Media Card Pass through Command
  - Support 48 bit Address feature set.
- Size; Half-Size mSATA
- Compatible with Windows 7 / Vista / XP SP3 Microsoft Inbox driver support

## System Requirements:

- Half-Size mSATA slot

## MR17 Package Contents



Screw x2

MR17  
(mSATA to Dual microSDXC /UHS-I adapter) x1

As a New manufacturer of quality computer connectivity products since 2009/Mar, BPLUS technology brings to market a broad range of upgrade products. These products bridge the connection between Desktop/Notebook systems and external peripherals.



Professional I/O adapter provider

**Bplus Technology Co., Ltd.**

Address: 9F-1, NO.88, ZHOU-TZYY ST.,  
NEI-HU, TAIPEI, TAIWAN, R.O.C  
TEL: +886-2-7736-0128  
FAX: +886-2-7736-0126  
Email: sales@bplus.com.tw  
http://www.Bplus.com.tw